

SRHP320/300TC-G16

SRHP320 retract thruster hydraulic G16

Spare parts (valid from 2020-11-27)



SLEIPNER

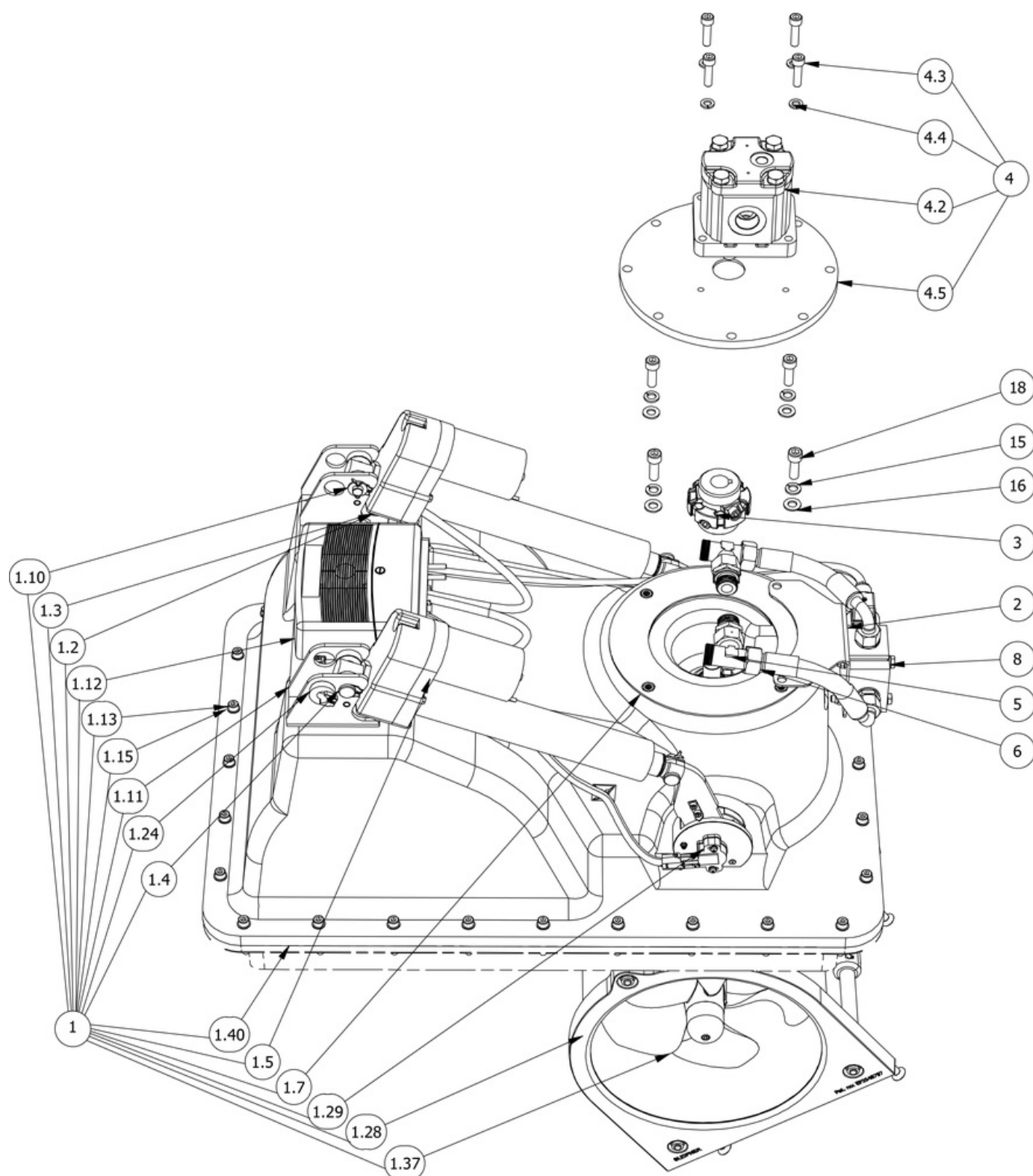

#	Name	Item Code	Description
1	Retract Mechanical SRV 300	20 0651	Retract mechanical SRV300 Common
1.10	DIN 125 - A 13	212125	Washer M12
1.11	Bracket for actuator	140843	Bracket actuator SRV300
1.12	Electronic control unit SRV	150000	Electronic Control Unit SRV
1.13	DIN 912 - M8 x 55	7 1080	Bolt M8 x 55 Unbraco
1.15	DIN 125 - A 8.4	208125	Flat washer M8 A4
1.2	DIN 127 - A 10	210127	Spring lock washer M10
1.24	Grommet	SM153576	Grommet
1.28	Tunnel mechanism	SM157566	Tunnel mechanism for SRV300
1.29	Horizontal axis right side	SM157569	Horizontal shaft SRV300, right side
1.3	DIN 912 - M10 x 16	11216	Bolt M10x16 Unbraco
1.37	Q-Prop Ø300 RH	SM-130945 (RH)	Thruster propeller 5bl Q-Prop™ for SE300 RH
1.4	Locking bolt	140002	Lock bolt, upper actuator
1.40	Housing for SRV 300	141017	Cover chassis for thruster SRV300TC
1.5	Actuator	140873	Actuator SRV300
1.7	Friction gasket	140815	Friction seal SRV285
2	Bracket valve SRH300T	141225	Bracket valve SRH300
3	Centa Flexi coupling Ø15 Ø22 - 10 50CFB76	SM153534	Flexible coupling SRH300
4	Hyd.motor mounted SRH300 U16ccm	102115UL4	Hydraulic motor SRH300 16cm³ gear motor
4.2	Hyd. motor 16 ccm		72101/U-16
4.3	DIN 912 - M8 x 30	6 1360	Bolt M8 x 30 Unbraco
4.4	DIN 127 - A 8	208127	Spring lock washer M8
4.5	Adapterplate	20 21301	Adapter plate SH300
5	Cutting ring fitting		HS 6061-18-19
6	Hydr connection		HSS 1105-08-02
8	2 port shut off valve	HF-NO-004	2-port shutoff valve NO 1/2"
15	DIN 127 - A 10	210127	Spring lock washer M10
16	DIN 125 - A 10.5	210125	Washer M10
18	DIN 912 - M10 x 30	20 1360	Bolt M10x30 Unbraco

The installer alone has responsibility for the installation of the spare parts. Side-Power only warranty the spare parts supplied only.

The information given in the document was correct at the time it was published. However, Sleipner Motor AS can not accept liability for any inaccuracies or omissions it may contain. Continuous product improvement may change the product specifications without notice. Therefore, Sleipner Motor AS can not accept liability for any possible differences between product and document.