

**20 1180 A**  
**Anode, aluminium SE120-SE300**

**Spare parts (valid from 2023-01-18)**

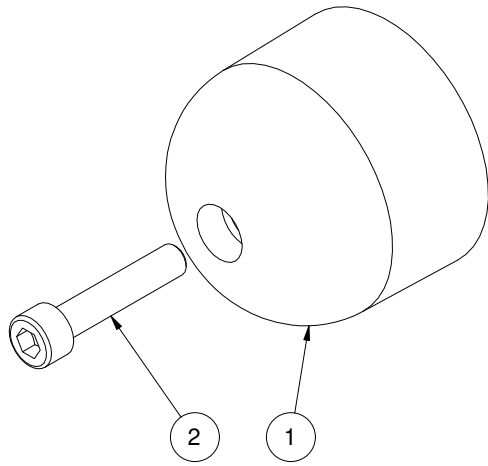

**SLEIPNER**



<b>#</b>	<b>Quantity</b>	<b>Name</b>	<b>Item Code</b>	<b>Description</b>
1	1.00	Alu anode	10 9998	Anode, aluminium SE130/170/SP240/285
2	1.00	Bolt		DIN 912 - M6 x 30

The installer alone has responsibility for the installation of the spare parts. Side-Power only warranty the spare parts supplied only.

The information given in the document was correct at the time it was published. However, Sleipner Motor AS can not accept liability for any inaccuracies or omissions it may contain. Continuous product improvement may change the product specifications without notice. Therefore, Sleipner Motor AS can not accept liability for any possible differences between product and document.