

2 0101 12

Electric motor SE30 12V

Spare parts (valid from 2022-05-04)



SLEIPNER

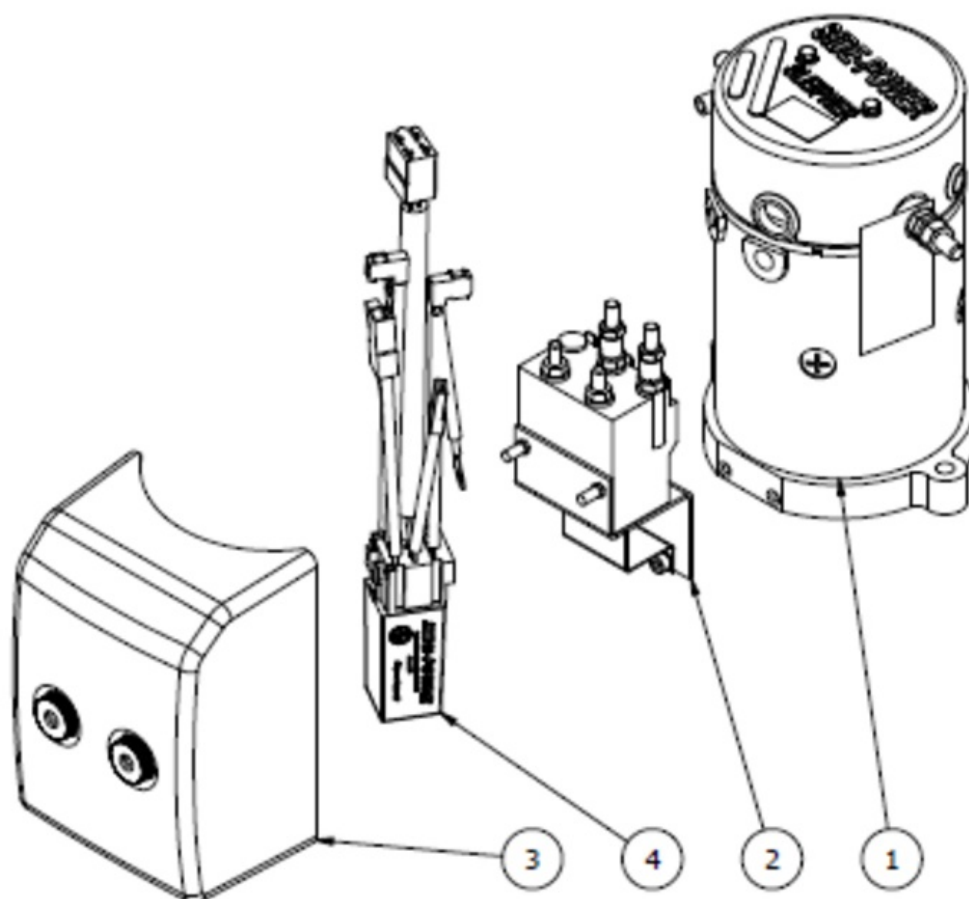

#	Quantity	Name	Item Code	Description
1	1.00	Electric motor		--
2	1.00	Solenoid	41571122	Solenoid SE20/25/30
3	1.00	Solenoid cover kit	SM168196	Solenoid cover kit SE20-30
4	1.00	Controller	SM159145	Controller SE25/30 12V
*5	1.00	Brushes for motor (kit)		--
*6	1.00	Brushes spring for motor (kit)		--
*7	1.00	Temp switch		--

(*5) Please provide thruster serial # when ordering brushes for motor.

(*6) Please provide thruster serial # when ordering brushes spring for motor.

(*7) Please provide thruster serial # when ordering temp switch.

The installer alone has responsibility for the installation of the spare parts. Side-Power only warranty the spare parts supplied only.

The information given in the document was correct at the time it was published. However, Sleipner Motor AS can not accept liability for any inaccuracies or omissions it may contain. Continuous product improvement may change the product specifications without notice. Therefore, Sleipner Motor AS can not accept liability for any possible differences between product and document.